

WBOV3A2

WALL BRACKET WITH SUPPORT PLATE AND WEATHERPROOF JUNCTION BOX



DESCRIPTION

Die-cast aluminium reinforcing support plate in weather-proof box, supplied with WBOVA2 bracket. When combined with a cable managed bracket, it allows wiring internally throughout the unit. The sealing rings OWBIP2 or OWBIP3 ensure a housing of IP66 protection.

TECHNICAL DATA

MECHANICAL

Made of aluminium

Internal cable management directly to the box

Load rating: 25kg (55lb)

Length: 204mm (8in)

The sealing rings OWBIP2 or OWBIP3 ensure an IP66 protection to the housing

Unit weight: 2.4kg (5.3lb)

PART NUMBER

WBOV3A2 Wall bracket with internal cable channel, counterplate and support box, not compatible with OHEBVF1, OHEBVF2 and OHEBVF3

PACKAGE

Model Number	Weight	Dimensions (WxHxL)	Master carton
WBOV3A2	2.5kg (5.5lb)	11x19x53cm (4.3x7.5x21in)	-

TECHNICAL DRAWINGS

The indicated measurements are expressed in millimetres.

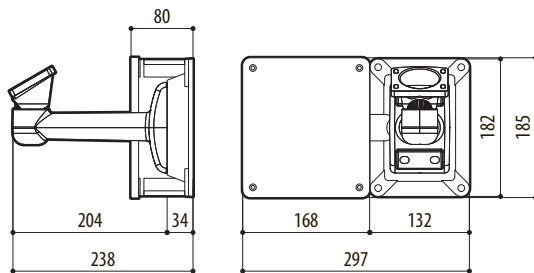

WBOV3A2